

**ORDER OF BOARD OF SUPERVISORS Madison COUNTY,
SETTING FORTH PROPOSED STATE AID PROJECTS FOR
PERIOD January 1, 2016 THROUGH December 31, 2019**

Pursuant to the provisions of Senate Bill No. 1 of the Extraordinary Session of 1949 and as subsequently amended, herein after referred to as said Act, We, the undersigned members of the Board of Supervisors of Madison County, hereby order that the proposed project(s) listed herein constitute the State Aid Program for Madison County for the period January 1, 2016 through December 31, 2019.

In support of this order, the Board certifies and agrees that:

1. The State Aid System in said County has been designated by the Board and approved by the State Aid Engineer, as required by said Act.
2. The Board has employed a Registered Professional Engineer as County Engineer, who will employ such other competent technical assistant(s), as required, to properly supervise and inspect the work in compliance with the Rules and Regulations of the State Aid Engineer, all as required in said Act.
3. This program, which has been prepared by the County Engineer and approved by this Board, is herewith submitted to the State Aid Engineer for approval.
4. The Board will comply with all applicable Laws, Rules and Regulations in the acquisition of rights-of-way and will maintain the acquired rights-of-way for said project(s) to keep the same free of encroachments such as buildings, fences or any other obstructions. The Board designates Katie Bryant Snell as its right-of-way acquisition agent for the project(s) herein. The agent's address and phone number is 741 Avignon Drive, Suite A, Ridgeland, MS 39157 phone 601-460-9800.
5. Counties receiving \$500,000 or more in Federal funds from all projects constructed or being constructed in a Federal Fiscal Year (October 1 - September 30), must have a single audit conducted in accordance with OMB circular A-133.
6. The Board herein affirms its acceptance of the Office of State Aid Road Construction's policy for the accommodation of utilities as stated in S.O.P. No. SA II-2-8 and agrees to coordinate utility facility installation and/or adjustment in a timely manner so as not to impede project development.
7. The Board will maintain the project(s), after completion, in a regular and satisfactory manner subject to the approval of the State Aid Engineer, all as required in said Act.
8. The State Aid Engineer is authorized to effect such transfer of funds as are necessary to pay engineering costs on the project(s), as authorized by Mississippi Code 1972, Section 65-9-15, and in accordance with the Rules and Regulations promulgated by the State Aid Engineer, dated July 1, 2005.
9. The State Aid Engineer is authorized to effect such transfer of funds as are necessary to pay testing expenses incurred PRIOR to the award of Contract on any project(s) included in this program. In the event the Board cancels or withdraws any project(s) included in this program, the Board hereby agrees to reimburse its State Aid Fund for testing charges incurred.

State Aid Program for Madison County

PROJECT PRIORITY NO.

- 1. Project No. SAP 45(15)M
2. Name of Road: North Old Canton Road
3. Design Classification: (check one) Rural [X] Urban (check one) Collector [X] Local
4. Termini of Project: BOP Dave Brown Road (S36, T8N, R2E) BOP Yandell Road (S19, T8N, R3E) Previous Projects RS-0592(3)B, STP-0592(6)B, S0592(2)B
5. Length of Project: 1.95 Miles
6. Character of Work (Show Alternates if Applicable) overlay

- 7. Design Data:
a. Traffic Count: How Determined CMPDD Current ADT 2,600 VPD; Design Year ADT VPD; %Trucks 4 Traffic Count Required: Yes No [X] (Attach Supplemental Sheet)
b. Terrain Level [X] Rolling Design Speed 40 MPH
c. ROW: Existing 60 Ft.; Proposed Ft.
d. Proposed Roadway Crown Width 26 Ft.
e. Surface Type & Width: Existing HBSC 20 Ft. Proposed HBSC 20 Ft.

- 8. Bridges:
a. Str. No. Suff. Rtg. Capacity Remain in Place: Yes No Existing/Proposed Width Ft.
b. Str. No. Suff. Rtg. Capacity Remain in Place: Yes No Existing/Proposed Width Ft.
c. Str. No. Suff. Rtg. Capacity Remain in Place: Yes No Existing/Proposed Width Ft.
d. Str. No. Suff. Rtg. Capacity Remain in Place: Yes No Existing/Proposed Width Ft.
e. Str. No. Suff. Rtg. Capacity Remain in Place: Yes No Existing/Proposed Width Ft.

- 9. Estimated Construction Cost of Project (Including Contingencies) \$ 446,355
a. STP Funds Requested (%) \$
b. BR Funds Requested (%) \$
c. SA Funds Requested (100 %) \$ 446,355
d. LSBP Funds (%) \$
e. Funds \$

Engineering Cost (12 %) (Constr. Cost Less Contingencies) \$ 51,012

- a. State Aid Funds Requested \$ 51,012
b. County Funds Contributed \$
c. LSBP Funds Contributed \$
d. Funds Contributed \$

Total Estimated Cost of Project \$ 497,367

Construction will be by: Contract [X] County Forces

Use Supplemental Sheet and/or maps if needed to provide complete data.

Table with 2 columns: Action and Date. Rows include Preliminary Review, Recommend Approval, Approved, Letter To Bd., Funds Record, Programmed.

State Aid _____ Program for Madison County

BOARD OF SUPERVISORS

_____, County
_____, Supervisor, District I
_____, Supervisor, District II
_____, Supervisor, District III
_____, Supervisor, District IV
_____, Supervisor, District V

Prepared by: , County Engineer

STATE OF MISSISSIPPI
COUNTY OF Madison

This is to certify that the foregoing is a true and correct copy of an order passed by the Board of Supervisors of Madison County, Mississippi, entered into the minutes of the said Board of Supervisors, Minute Book No. _____, Page No. _____, same having been adopted at a meeting of said Board of Supervisors on the _____ day of _____, 2016.

Clerk of Board of Supervisors of
Madison County, Mississippi

**OFFICE OF STATE AID ROAD CONSTRUCTION
MISSISSIPPI DEPARTMENT OF TRANSPORTATION
JACKSON, MISSISSIPPI**

DATA TO BE SUBMITTED WITH ALL PROJECT PROGRAMS

Project Number SAP 45(15)M County Madison Date April, 2016

Road Connections at each End of Project
South End, Surf. Type HBSC Surf. Width 20 Rdwy. Width 26
 (South or West)
North End, Surf. Type HBSC Surf. Width 20 Rdwy. Width 26
 (North or East)

Railroad Grade Crossing Data
 Is there an existing Railroad Grade Crossing? Yes _____ No

Name of Railroad N/A

Existing Protection _____

Proposed Protection _____

Existing and/or Proposed Facilities Effecting Route:

SCHOOLS: YES _____ NO ON ROUTE _____ OFF ROUTE _____
 INDUSTRY: YES _____ NO ON ROUTE _____ OFF ROUTE _____

TYPE OF INDUSTRY: N/A

OTHER DESIGN CONSIDERATIONS: _____

UTILITY COMPANIES TO BE AFFECTED BY PROJECT:

NAME	STREET OR P.O. BOX ADDRESS	CITY
Unknown		

Signed 
 County Engineer

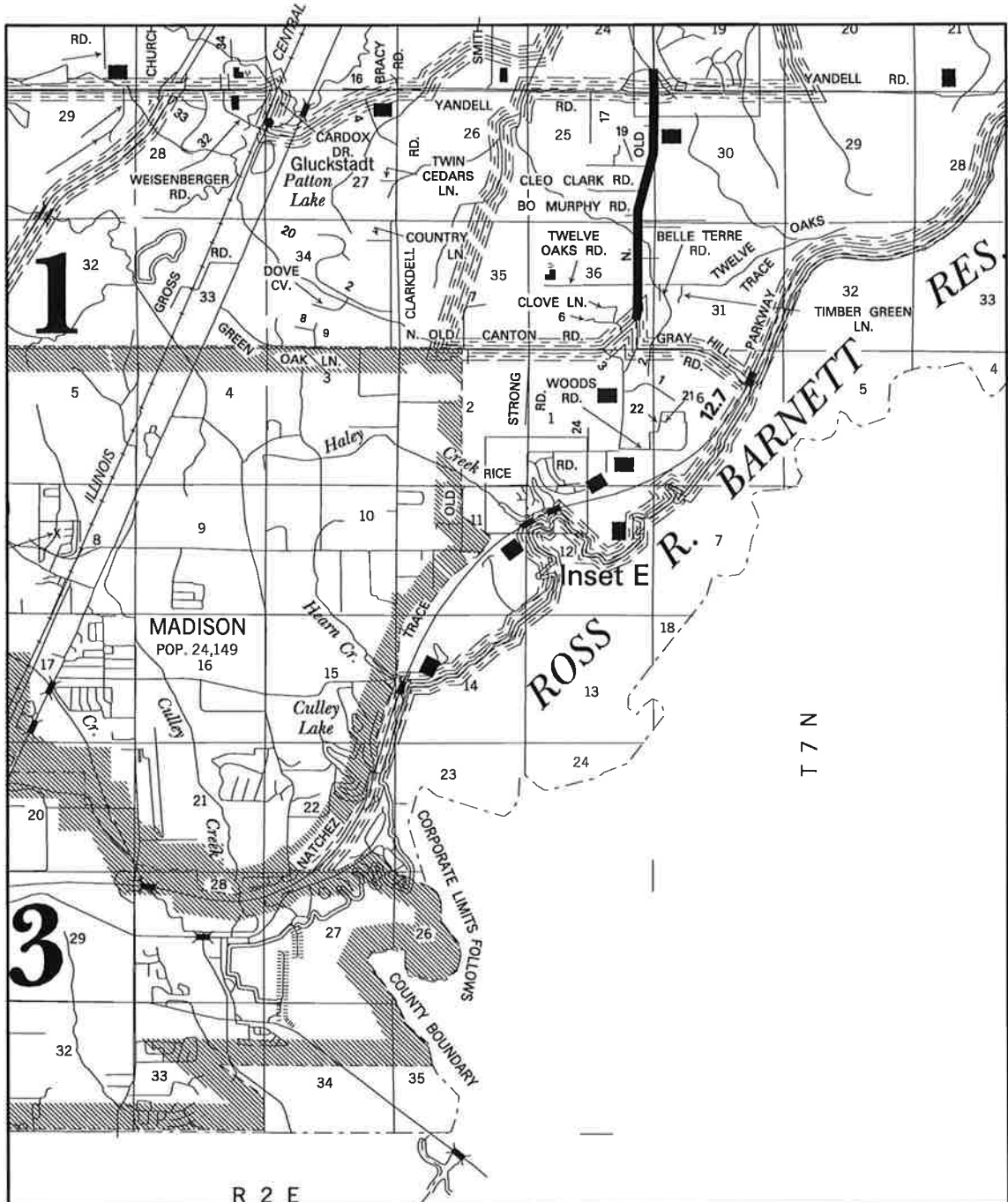

LEGEND:
 PROJECT LOCATION 
 ROADS 

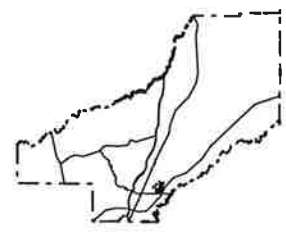

VICINITY MAP

MSEG 143-A LeFluors Square
 Jackson, MS, 39211
 (601) 355-9526

LOCATION MAP
 NORTH OLD CANTON ROAD
 STATE AID PROJECT

DRAWING REVISIONS		
NO.	REMARKS	DATE

SHEET NUMBER:
 1 OF 1